

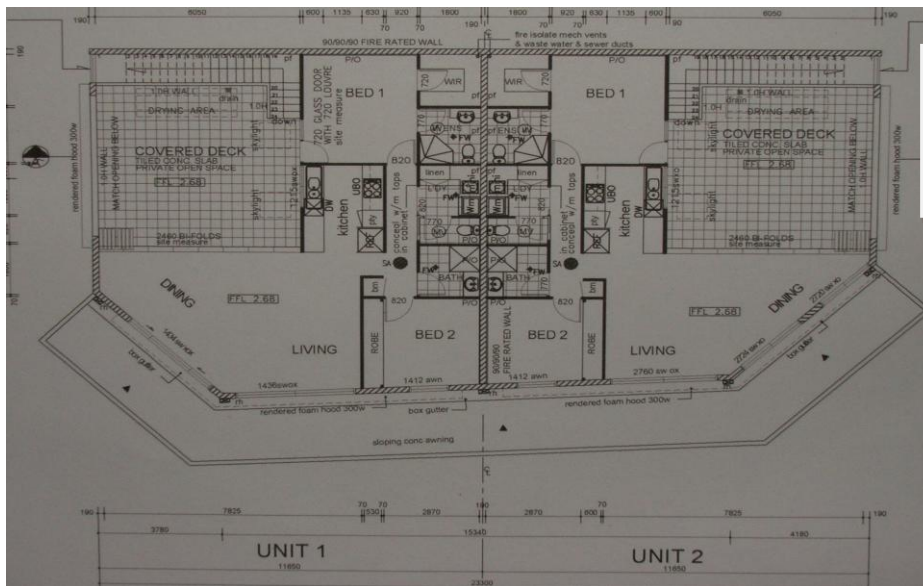

PACIFIC PARADISE APARTMENT LIVING



LARGE APARTMENTS
2 Bedroom, Ensuite, Turn Key,
Huge Balcony
\$345,500*



CENTRAL SUNSHINE COAST – BRAND NEW HOME

- Large residential units only \$345,500
- Each unit TOTAL 180 square metres
- Close to MUDJIMBA Beach
- Near Twin Waters Resort and Hyatt Coolum

Fabulous location with neighbouring beaches, this unit is brand new and totals approximately 180 square metres! Just one of two units in a small block, this Pacific Paradise apartment features open plan living. Bright and breezy with large open plan living spaces, and designed for the fastidious buyer with two bedrooms, two bathrooms (one ensuite), study nook and living area designed for comfort. Finished with quality fixtures and fittings.

Downstairs features a secure basement with double garage and lockable storage space. Two small commercial shops are downstairs with the building due for completion early 2010. Located in Karome Street, the unit is set back from David Low Way though makes an ideal home for those who appreciate the airport nearby or require fast access to the Sunshine Coast Motorway. Close to amenities, yet quiet and within walking distance to the shops and tavern.

Complemented by a golf resort, fabulous beaches and a host of cafes and restaurants nearby, this Pacific Paradise unit should not be overlooked.

Call Warren Kelly on 0412 092 758
www.propertylynx.com.au